



COOLER RCX-Z5

USER Manual

www.rosewill.com

Thank you for purchasing a High-Quality Rosewill Product.

Please register your product at : www.rosewill.com
for complete warranty information and future support for your product.

INTEL Installation

Preparations

Turn off the computer and unplug all cables. Open the computer to remove any existing cooler carefully. Using tissues to clean the CPU surface and remove any remaining paste. To release the clips of the existing cooler; rotate the head of the clips by 90° using a slotted screwdriver (-) and pull the clip upward.



1. Please attach the clip for socket 775 with heatsink base by using 4 screws.



2. Apply paste to the middle of CPU surface. Use approximately 1/2 of the injection. Keep the paste in the center and do not spread the paste.



3. The four plastic clips must first be aligned in the right position; turn the black plastic head clockwise. Align the cooler horizontally in the standard ATX case.



Be careful to keep away fan cable from fan.

4. The metal clips have been given numbers 1 and 2. Press down both numbers 1 at the same time and repeat this step with numbers 2.

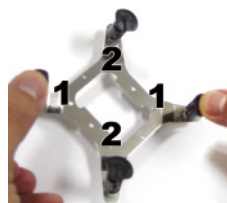

5. After checking the correct fit of the clips, press the black clip head downward until they click into place by using fingers and a slotted screwdriver (-) together.

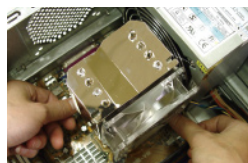

6. Attach the power plug of cooler onto the power socket of motherboard. Close your case properly, reconnect the cables and turn on your computer.



AMD Installation

Preparations

Turn off the computer and unplug all cables. Open the computer to remove any existing cooler carefully. Using tissues to clean the CPU surface and remove any remaining paste.

1. Fasten the pair of clips for AMD with heatsink base by using 4 screws.

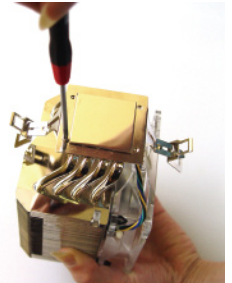

2. Apply paste to the middle of CPU surface. Use approximately 1/2 of the injection. Keep the paste in the center and do not spread the paste.



3. Position the cooler horizontally in the designated case as shown, Align the CPU cooler until it fits in the black CPU socket cradle in the right position.



Be careful to keep away fan cable from fan.

4. Hook the hole of one-side clip onto the lug of Retention frame, and hook the hole of another-side clip onto the lug of Retention frame. Press down the clip on the hooks and fasten the levers properly by using a finger and a phillips screwdriver (+) onto a hole together.

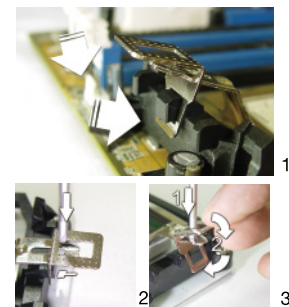

5. Attach the power plug of cooler onto the power socket of motherboard. Close your case properly, reconnect the cables and turn on your computer.



Advice : For enjoying the very low noiselevel of your cooler, please check also the noiselevel of other components of your system (system fans, chipset cooler, power supply and VGA cooler)